



ENG

WEARABLEX

SL-WA100

Manual



Before using the light, read this manual thoroughly and keep it for future reference.

Design Pat. Pending
Copyright © 2018 CATEYE Co., Ltd.
SLWA100-180308 3



⚠ WARNING!!!

- Check periodically to ensure that the light unit is attached securely. Do not use a damaged rubber band.
- Always attention to the remaining battery power by checking the indicator periodically while using.

⚠ CAUTION!

- Stop your bicycle to operate the switch.
- Do not place it within children's reach.
- This unit is not totally waterproof. Please wipe and dry it completely after using in rain. Otherwise, it may cause failure.
- If the light unit or parts become dirty with mud, etc., clean with a soft cloth which is moistened with mild soap. Never apply paint thinner, benzene or alcohol; damage will result.

⚠ LITHIUM-ION BATTERIES

Cautions on recharging

- We recommend using 500+mAh (USB2.0) USB battery charger.
- Avoid charging in direct sunlight or in a vehicle parked under direct sunlight, and make sure to charge only when the ambient temperature is between 5 and 40°C.
- Before charging, be sure that no dust or other foreign objects attach to the USB plug.
- Do not subject the light to vibrations while charging.
- When your PC is in sleep state, the unit cannot be charged.
- Once charging is complete, be sure to disconnect the USB plug.
- Charging and lighting times are approximate values, and will vary by environmental and user conditions.

Cautions in use

- Charging, discharging, and storing in high temperatures will cause the rechargeable battery to deteriorate faster. Do not place the light inside a vehicle or near a heater.
- If the illumination time is significantly reduced even after proper charging, the rechargeable battery may be nearing the end of its service life. Dispose of the battery as described in "Cautions for dispose".

Cautions on storage

Cool and dry storage is recommended. For long period storage, it is important to charge the battery 30 minutes every 6 months.

Cautions for dispose

When disposing of the light unit, remove the internal rechargeable battery and dispose of it according to local regulations.

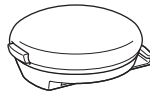

Light unit + Clip bracket

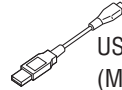

USB cable (MICRO USB)



Rubber band and hook

1 HOW TO CHARGE

⚠ Always charge the product before use.

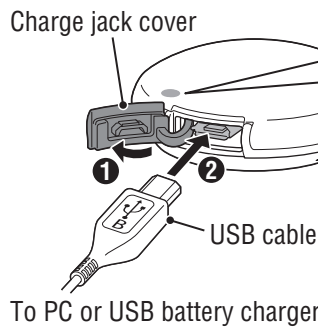

Indicator

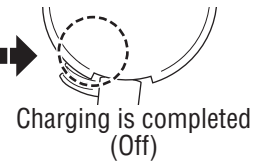

Standard charging time

Approx. 2 h (USB 2.0)

2 HOW TO MOUNT

How to mount the unit on your backpack

- 1 Confirm the jack cover of the light unit facing the clip bracket tab, and snap the unit on the bracket.
- 2 Remove the unit from the bracket by turning the unit to the left or right.

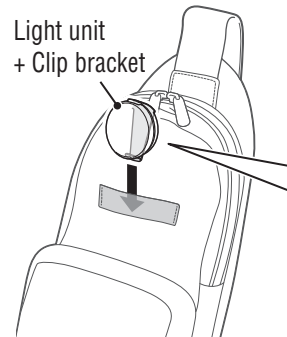

Remove / Install clip bracket

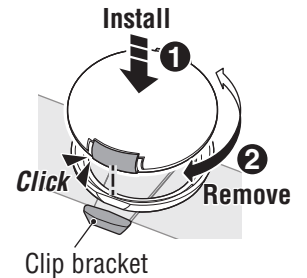

How to mount the unit on your bicycle

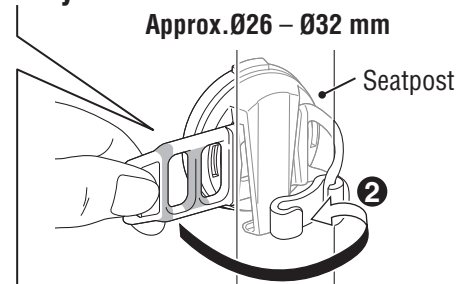
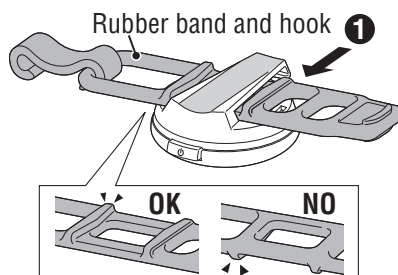

3 SWITCH OPERATION

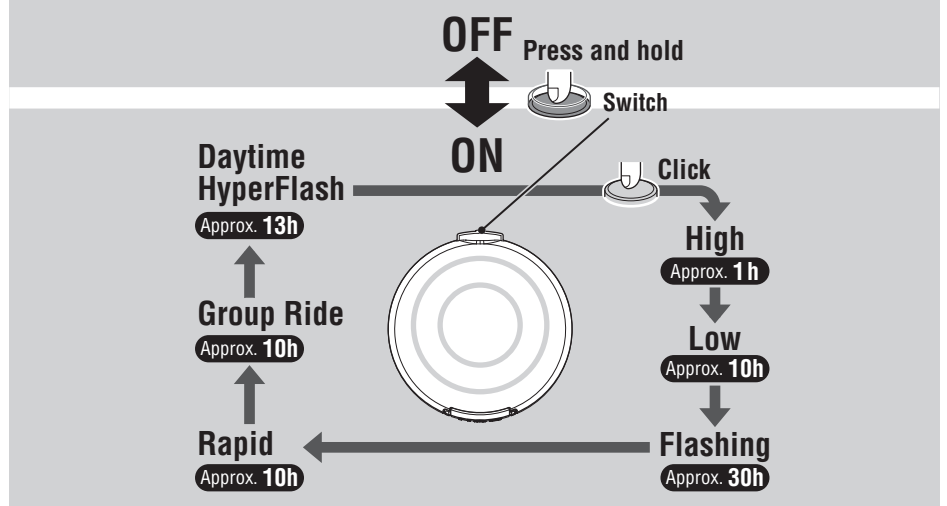

Automatic battery-saving function :

When the remaining battery power is low, the lighting mode changes to slow flashing. Charge the light as soon as possible.

SPECIFICATIONS

Battery	: Rechargeable lithium-ion polymer battery (200 mAh)
Temperature range	: 14°F – 104°F (-10°C – 40°C)
Recharge/discharge number of times	: About 300 times (until the rated capacity drops to 70%)
Dimensions/weight	: 1-51/64" x 1-47/64" x 5/8" (45.5 x 44 x 16 mm) / 0.58 oz (16.5 g)

*The specifications and design are subject to change without notice.

SPARE/OPTIONAL PARTS

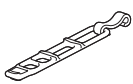

5442620
Rubber band and hook
(WA100)

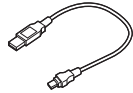

5342730
USB cable
(MICRO USB)



5442610
Clip bracket

LIMITED WARRANTY

2-year Warranty: Light unit only (excludes battery deterioration)

CatEye products are warranted to be free of defects from materials and workmanship for a period of 2 years from original purchase. If the product fails to work during normal use, CatEye will repair or replace the defect at no charge. Service must be performed by CatEye or an authorized retailer. To return the product, pack it carefully and enclose the warranty certificate (proof of purchase) with instruction for repair. Please write or type your name and address clearly on the warranty certificate. Insurance, handling and transportation charges to CatEye shall be borne by person desiring service.

For UK and REPUBLIC OF IRELAND consumers, please return to the place of purchase. This does not affect your statutory rights.

CATEYE CO., LTD.

2-8-25, Kuwazu, Higashi Sumiyoshi-ku,
Osaka 546-0041 Japan
Attn: CATEYE Customer Service Section
Phone : (06)6719-6863
Fax : (06)6719-6033
E-mail : support@cateye.co.jp
URL : <http://www.cateye.com>

[For US Customers]

CATEYE AMERICA, INC.
2825 Wilderness Place Suite 1200,
Boulder CO 80301-5494 USA
Phone : 303.443.4595
Toll Free : 800.5.CATEYE
Fax : 303.473.0006
E-mail : service@cateye.com